

Industrial Distributors

The maintenance stops here!

NEVER CHANGE POINTS AGAIN!



PerTronix has been the leading producer of electronic ignition distributors for industrial engines since 1985. Most gas and propane Wisconsin and Continental engines are factory equipped with our industrial distributor. Proven performance with reduced maintenance downtime, improved fuel economy and faster starts every time extending spark plug life two to three times.

These distributors will directly replace many Delco and Prestolite distributors quickly and easily. Distributors feature Ignitor technology with Hall Cell sensing eliminating the need for points and condenser. The light weight but strong housings have a superior venting system and come with a non-tracking cap, rotor and dust cover. An "O" ring seal reduces oil leakage around the distributor.



IGNITOR
ELECTRONIC IGNITION

Features and Specifications:

- Ignitor technology
- Epoxy encapsulated module protects against moisture, dust, dirt and oil.
- No external electronic "black box" required.
- Precision engineered to switch twice the energy of any other electronic ignition system.
- Timing remains constant with an amazing 1/4° accuracy all the way down to zero RPM.
- Temperature range -50 to 300° F with coil rise time of 25 microseconds over the entire temperature range.
- Effective RPM range of 0 to 6000
- Warranty: 30 months Ignitor module / 90 days mechanical

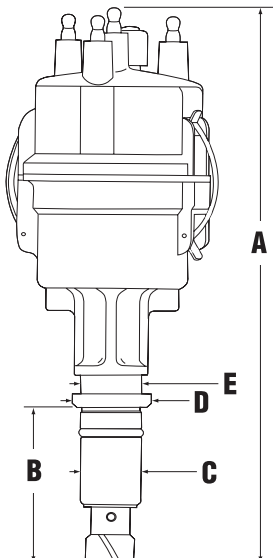

Part No.	Dimensions					Drive	Rotation
	A	B	C	D	E		
D11-18A	6.30	2.67	1.06	N/A	N/A	N/A	CCW
D21-11A	8.29	2.85	1.06	N/A	N/A	GEAR	CW
D21-12A	7.88	2.46	1.06	N/A	N/A	GEAR	CCW
D33-03A	9.51	2.71	1.06	1.36	1.05	GEAR	CCW
D33-03AM	9.51	2.71	1.06	1.36	1.05	GEAR	CCW
D41-01A	8.55	2.34	1.06	1.60	1.12	TANG	CW
D41-05A	7.58	1.31	1.06	1.36	1.05	TANG	CCW
D41-09B	7.88	2.62	1.06	N/A	N/A	GEAR	CCW
D41-10B	7.88	2.66	1.06	N/A	N/A	GEAR	CCW
D41-19A	8.80	2.53	1.06	1.60	1.12	TANG	CW
D41-20A	8.25	2.13	1.06	1.69	1.05	GEAR	CCW
D43-04B	9.21	2.71	1.06	1.36	1.05	GEAR	CCW
D61-06A	7.64	1.31	1.06	1.36	1.05	TANG	CCW

IGNITOR
IGNITOR II

FLAME-THROWER
DISTRIBUTORS

IGNITION
BOXES

IGNITION
COILS

IGNITION
MODULES

SPARK PLUG
WIRES

INDUSTRIAL
DISTRIBUTORS

Distributor Applications

Year	Cylinders	Make / Model	Part No.
Allis Chalmers			
1974-69	4	All Models with clockwise rotation distributor	D41-19A
Continental (Teledyne)			
All	3	TM-20 engine Models	D33-03A
All	4	TM-27 engine Models	D43-04B
1965-40	4	F4 Series "L" Head engine F124, F140, F162, (Top Outlet)	D41-05A
1992-65	4	F4 Series "L" Head engine F163 (Top Outlet)	D41-05A
1992-65	4	Y4 Series "L" Head engine Y112 (Top Outlet)	D41-05A
1965-40	6	F6 Series "L" Head engine F209, F218, F224, F226, F244 (Top Outlet)	D61-06A
1992-65	6	F6 Series "L" Head engine F227, F245, (Top Outlet)	D61-06A
The PerTronix 4 cylinder and 6 cylinder distributors replace the original Prestolite and/or Delco-Remy distributors in Continental engines. F4, F6 and Y4 series engines manufactured since 1965 require no modifications. On engines prior to 1965 some modifications may be necessary.			
Perkins			
Up to 1992	4	G4236 engine	D41-20A
Waukesha			
1992-70	4	D155G, D176G, VRG220	D41-01A
Wisconsin (Teledyne)			
1992-55	1	TWM engine model BKN	D11-18A
1992-57	1	TWM engine model AENL	D11-18A
1992-68	2	TWM engine model TJD	D21-12A
1992-80	2	TWM engine model W2-1230, W2-1235	D21-11A
1992-80	2	TWM engine model W2-880	D21-12A
1992-87	2	TWM engine model W2-1250	D21-11A
1992-56	4	TWM engine model VH4D (side mount)	D41-09B
1992-56	4	TWM engine model VH4D (top mount)	D41-10B
1962-67	4	TWM engine model V65D (side mount)	D41-09B
1992-75	4	TWM engine model W4-1770 (top mount)	D41-10B
1992-76	4	TWM engine model W4-1770 (side mount)	D41-09B

Distributor Cross Reference:

Clark		F226M-00421	D61-06A	F600M-00305	D61-06A	Y112M-00500	D41-05A
1636495	D41-01A	F226M-00424	D61-06A	F600M-00314	D61-06A	Y400M-00281	D41-05A
2372353	D41-01A	F226M-00433	D61-06A	F600M-00373	D61-06A	Y112M-00311	D41-05A
914528	D43-04B	F226M-00436	D61-06A	F600M-00380	D61-06A	Y91M-00411	D41-05A
Colt		F244M-00406	D61-06A	F600M-00405	D61-06A	Delco	
FMD1C7	D11-18A	F244M-00414	D61-06A	F600M-00439	D61-06A	1110021	D61-06A
FMD2C7	D21-12A	F244M-00523	D61-06A	F600M-00440	D61-06A	1110060	D61-06A
FMD2C7-B	D21-11A	F226M-00503	D61-06A	F600M-00449	D61-06A	1110305	D61-06A
FMD4C7	D41-09B	F400M-00305	D41-05A	F600M-00451	D61-06A	1110306	D41-05A
FMD427A	D41-10B	F400M-00307	D41-05A	F600M-00502	D61-06A	1110402	D41-05A
Continental		F400M-00392	D41-05A	F600M-00508	D61-06A	1110420	D41-05A
F162M-00232	D41-05A	F400M-00533	D41-05A	F600M-00509	D61-06A	1110423	D41-05A
F162M-00311	D41-05A	F400M-00411	D41-05A	F600M-00510	D61-06A	1111310	D41-05A
F162M-00315	D41-05A	F400M-00413	D41-05A	F600M-00518	D61-06A	1111356	D41-05A
F162M-00347	D41-05A	F400M-00449	D41-05A	F600M-00519	D61-06A	1111428	D41-05A
F162M-00412	D41-05A	F400M-00466	D41-05A	F600M-00525	D61-06A	1111429	D61-06A
F162M-00446	D41-05A	F400M-00472	D41-05A	TM13M-00501	D23-02A	1111432	D41-05A
F162M-00462	D41-05A	F400M-00503	D41-05A	TM20M-00500	D33-03A	1111576	D41-05A
F162M-00466	D41-05A	F400M-00507	D41-05A	TM20M-00501	D33-03A	1111620	D61-06A
F186M-00202	D61-06A	F400M-00516	D41-05A	TM20M-00503	D33-03AM	1111700	D41-01A
F226M-00304	D61-06A	F400M-00518	D41-05A	TM27M-00502	D43-04B	1111712	D41-05A
F226M-00309	D61-06A	F400M-00521	D41-05A	TM27M-00503	D43-04B	1111716	D41-05A
F226M-00404	D61-06A	F400M-00521	D41-05A	TM27M-00503	D43-04B	1111716	D41-05A
F226M-00407	D61-06A	F400M-00531	D41-05A	TM27M-00510	D43-04B	1111717	D41-05A
F226M-00416	D61-06A	F400M-00532	D41-05A	TM27M-00511	D43-04BM	1111728	D61-06A
		F401M-00405	D41-05A	Y112M-00237	D41-05A	1111895	D61-06A
		F401M-00406	D41-05A	Y112M-00305	D41-05A	1111913	D61-06A

continued on next page

IGNITOR
IGNITOR II

FLAME-THROWER
DISTRIBUTORS

IGNITION
BOXES

IGNITION
COILS

IGNITION
MODULES

SPARK PLUG
WIRES

INDUSTRIAL
DISTRIBUTORS

Distributor Cross Reference:

Delco (continued)

1112508	D61-06A
1112552	D61-06A
1112567	D61-06A
1112604	D41-05A
1112628	D61-06A
1112637	D41-05A
1112672	D61-06A
1112673	D41-05A
1112685	D41-01A
1112789	D41-05A
1112508	D61-06A

Mallory

YL-664A	D41-01A
---------	---------

Prestolite

IAD-4029	D41-05A
IAD-4029A	D41-05A
IAD-4033	D61-06A
IAD-6002-1F	D61-06A

IAD-6003-2H
IAD-6004-1E
IAD-6004-2F
IAD-6004-2N
IAD-6004-2P
IAD-6006-1
IBT-4101H
IBT-4105A
IBT-4105B
IBT-4201
IBT-4201
IBT-4705
IBT-4706
IBT-6501D
IBT-6702
IBT-6703
IDJ-4008
IDJ-4012
IDJ-4013
IDJ-4014
IDN-4012

D41-05A
D41-05A
D41-09B
D41-09B
D41-10B
D61-06A
D41-05A
D41-01A
D41-05A
D21-11A
D21-11A
D41-05A
D41-05A
D61-06A
D61-06A
D61-06A
D41-05A
D41-05A
D41-05A
D61-06A
D61-06A
D43-04B

IDN-4014
IDU-4403A
IDU-4403B
IDU-4406
IDU-4408
IGB-4045A
IGB-4304B
IGC-4722
IGC-6004-1
IGW-4139
IGW-4139C
IGW-4156A
IGW-4408
IGW-4412
IGW-6581B

Waukesha

60262K
69748A

D33-03A
D41-01A
D41-01A
D41-20A
D41-20A
D41-05A
D61-06A
D61-06A
D41-05A
D41-05A
D41-05A
D41-05A
D11-18A
D21-12A
D41-05A

Wisconsin

YF-10C	D41-09B
YF-10D	D41-10B
YF-35	D21-12A
YF-40	D21-12A
YF-42	D21-11A
YF-45	D41-09B
YF-45A	D41-10B
YF-46	D21-12A
YF-48	D21-11A
YF-49	D11-18A
YF-50, YF-50C	D41-09B
YF-50A, YF-50D	D41-10B
YF-50B, YF-50E	D41-11B
YF-51, YF-51A	D21-11A
YF-52, YF-52A	D21-12A
YF-53	D11-18A
YF-54, YF-54A	D21-13A
YF-55, YF-55A	D41-24A
YF-8C	D11-18A

Service Parts:

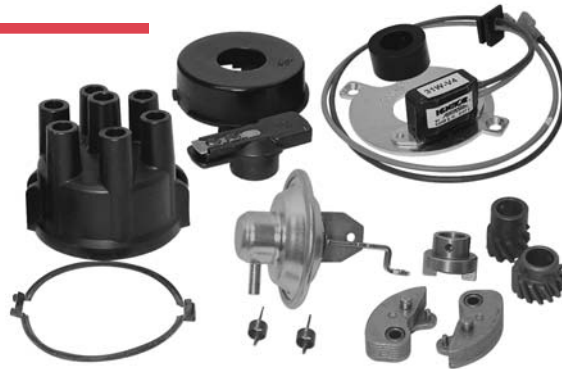

Distributor Number	Cap	Rotor	Dust Cover	Magnet Sleeve	Module	Vacuum Advance	Cap Gasket	Drive / Gear	Advance Springs	Advance Weights
Industrial Distributor Replacement Parts										
D11-18A	022-1101			026-101	025-004B		027-001		018-1006	019-1001
D21-11A	022-1203	020-1002	021-001	026-202	025-005B		027-001	023-1002	018-1005	019-1003
D21-12A	022-1202	020-1002	021-001	026-201	025-004B		027-001	023-1003	018-1004	019-1001
D21-13A	022-1204	020-1002	021-001	026-203	025-004B		027-001	023-1003	018-1004	
D33-03A	022-1301	020-1001	021-001	026-301	025-002B	024-001	027-002	023-1001	018-1001	019-1001
D33-03AM	022-1301	020-1001	021-001	026-301	025-006B		027-002	023-1001	018-1001	019-1001
D41-01A	022-1403	020-1003	021-001	026-401	025-008A		027-001	023-1004	018-1007	019-1003
D41-05A	022-1403	020-1003	021-001	026-401	025-003A		027-001	023-1005	018-1002	019-1001
D41-09B	022-1403	020-1002	021-001	026-401	025-003A		027-001	023-1002	018-1003	019-1001
D41-10B	022-1403	020-1002	021-001	026-401	025-003A		027-001	023-1002	018-1003	019-1001
D41-19A	022-1403	020-1003	021-001	026-401	025-007A		027-001	023-1006	018-1008	019-1003
D41-20A	022-1403	020-1003	021-001	026-401	025-003A		027-001	023-1007	018-1009	019-1001
D43-04B	022-1404	020-1001	021-001	026-401	025-001A	024-001	027-002	023-1001	018-1001	019-1001
D61-06A	022-1602	020-1003	021-001	026-601	025-003A		027-001	023-1005	018-1002	019-1001
D61-19B	022-1602	020-1003	021-001	026-601	025-007A		027-001		018-1008	019-1003